



81 Ruddlesway, Windsor, Berkshire, SL4 5SG  
£540,000

 **HORLER**

## 81 Ruddlesway, Windsor, Berkshire, SL4 5SG

Located in the sought-after area of Ruddlesway, Windsor, this delightful three-bedroom link-detached house offers comfortable and modern family living. The property features a spacious open-plan living, dining, and kitchen area, creating a bright and welcoming space ideal for relaxing and entertaining. Outside, the private rear garden includes a patio area and mature shrubs, providing a peaceful outdoor retreat. Additional benefits include driveway parking and a large garage for added convenience and storage. Situated close to local amenities and the picturesque surroundings of Windsor, this home is perfect for families or investors alike.



## Property Summary

This delightful three-bedroom semi-detached house, located in Ruddlesway offers a perfect blend of comfort and open plan living. Upon entering, you are welcomed into a spacious living and dining area that seamlessly flows into the well-appointed kitchen, creating an inviting space ideal for both relaxation and entertaining.

The property boasts three generously sized bedrooms and family bathroom, providing ample space for family or guests.

Outside, the rear garden is a true highlight, featuring a lovely patio area perfect for al fresco dining or enjoying a quiet moment in the sun. The garden is adorned with mature shrubs, adding a touch of greenery and privacy to your outdoor space.

For those with vehicles, the property includes driveway parking and a large garage, offering plenty of storage and convenience.

This home is not just a property; it is a sanctuary in a sought-after location, close to local amenities and the picturesque surroundings of Windsor. Whether you are looking to settle down or invest, this house presents an excellent opportunity for comfortable living in a vibrant community.

## General Information

Council tax band 'E'

## Legal Note

\*\*\*Although these particulars are thought to be materially correct their accuracy cannot be guaranteed and they do not form part of any contract\*\*\*.





# Ruddlesway SL4

Approximate Gross Internal Floor Area = 94.3 sq m / 1016 sq ft

Garage Area = 22.7 sq m / 245 sq ft

Total Area = 117.0 sq m / 1261 sq ft

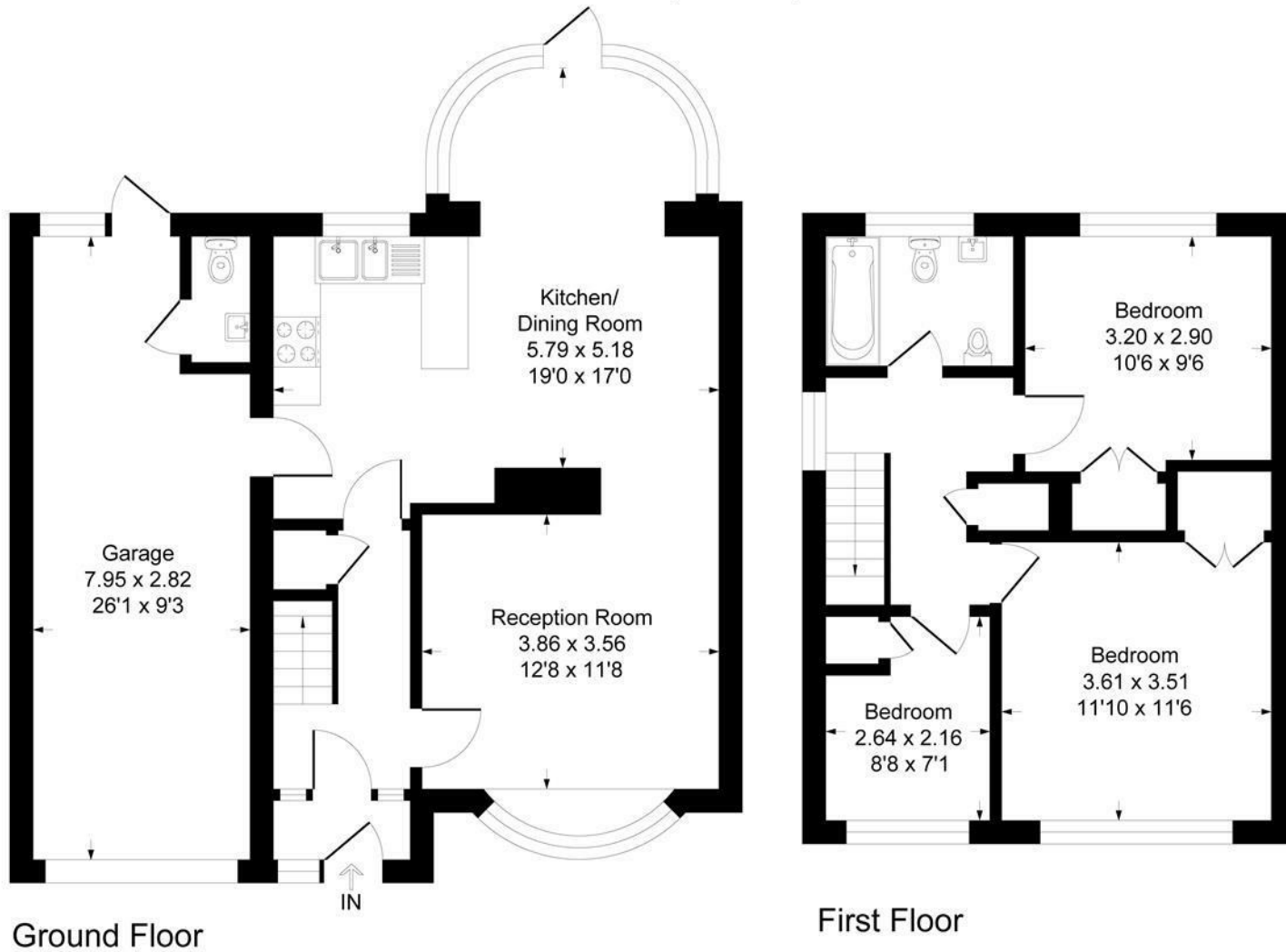

Illustration for identification purposes only, measurements are approximate, not to scale.  
Produced By Esjay Property Marketing